

Kenadrain I Channel 100mm wide with ductile iron gratings class C250 – Height 2

Code : DL102CF

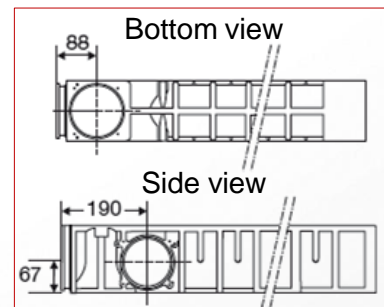
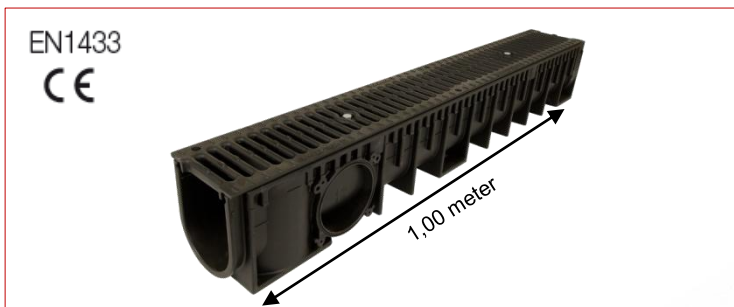
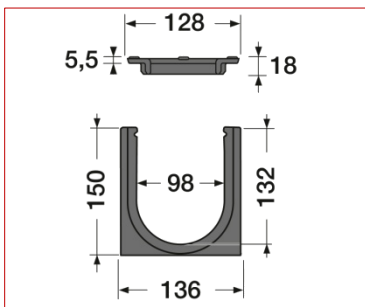

FUNCTION :

The drainage channel is designed to drain run-off water. In accordance with EN1433 standard and the **CE** marking, it can be used in public area in class C250.

DESCRIPTION :

It consists of:

- an injected recycled polypropylene black body
- two overlaying ductile iron gratings class C250
- 1 screw per grating on galvanized locking bar

ACCESSORIES :

To connect the channels to the underground network :

- end cap/end outlet Ø100 or 110 – NTDL102 or NVDL102
- lateral or vertical outlet Ø100, 110 or 125 – STDR10, SVDR10 or SXDR10
- sump unit with outlet Ø110 or 125 – PS100V or PS100X



NTDL102
NVDL102



PS100V
PS100X

CARACTERISTICS :

- Resistance class: C250
- Effective width: 98 mm
- Effective depth: 132 mm
- Grating type: Ductile iron
- Drainage surface: 404 cm²/ml
- Hydraulic section: 122 cm²
- Opening dimensions: 10 / 90 mm
- Weight: 10.6 Kg

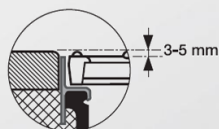

IMPLEMENTATION :

- X = 150 mm; L = 440 mm
- Z = 150 mm; Y = 80 mm; y = 80 mm

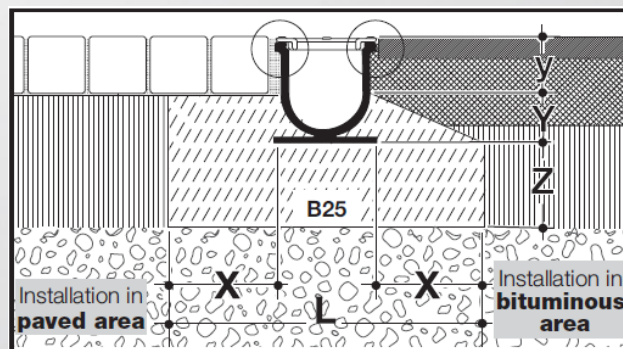

QUALITY - ENVIRONMENT :

ISO 9001
ISO 14001
BUREAU VERITAS
Certification



DATE : September 2014