

# Kenadrain I Park channel 100mm wide with heel ductile iron gratings class C250

Code : DR100CH

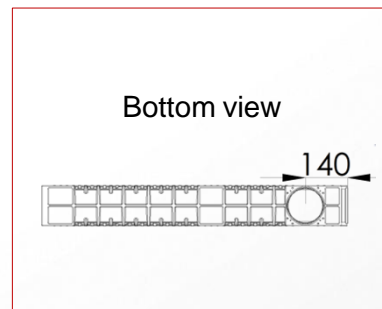
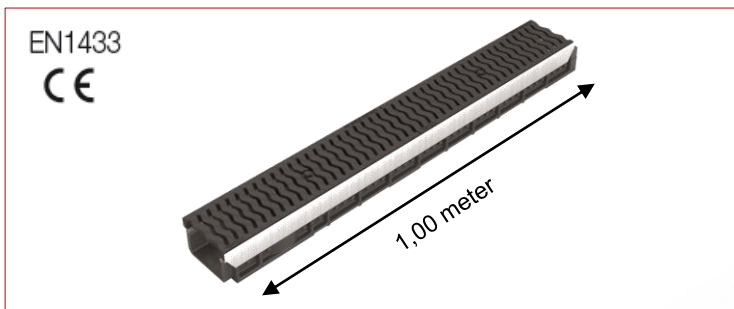
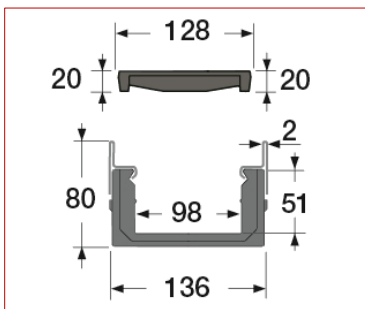

## FUNCTION :

The drainage channel is designed to drain run-off water. In accordance with EN1433 standard and the CE marking, it can be used in public area in class C250.

## DESCRIPTION :

It consists of:

- an injected recycled polypropylene black body
- two galvanized steel edges
- two black heel ductile iron gratings class C250
- 1 screw per grating on galvanized locking bar

Option : other colours are also available on request :

- red Laterite, yellow Pyrite, blue Basalt, grey Lunare and green Malachite



## ACCESSORIES :

To connect the channels to the underground network :

- end cap/end outlet Ø50 – NJDR100
- vertical outlet Ø100, 110 or 125 – STDR10, SVDR10 or SXDR10
- sump unit with outlet Ø110 or 125 – PS100V or PS100X



## CARACTERISTICS :

- Resistance class: C250
- Effective width: 98 mm
- Effective depth: 51 mm
- Grating type: Heel ductile iron
- Drainage surface: 300 cm<sup>2</sup>/ml
- Hydraulic section: 47.5 cm<sup>2</sup>
- Opening dimensions: 6 / 104 mm
- Weight: 11.2 Kg

## IMPLEMENTATION :

- X = 150 mm; L = 430 mm
- Z = 150 mm; y = 85 mm

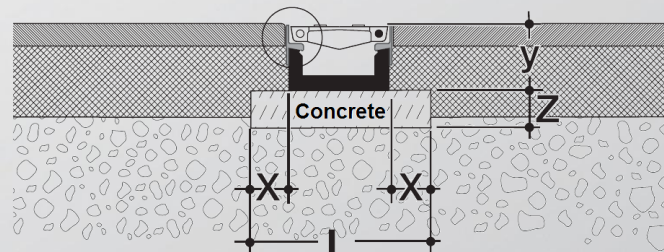
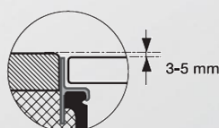

## QUALITY - ENVIRONMENT :

ISO 9001  
ISO 14001  
BUREAU VERITAS  
Certification



DATE : August 2014